

LAKE BANK WITH SECONDARY DRAINAGE

N.T.S.

NOTE: THIS SECTION IS OPTIONAL AND MAY BE IMPLEMENTED AT COMMON LOT LINES BY THE OWNER(S).

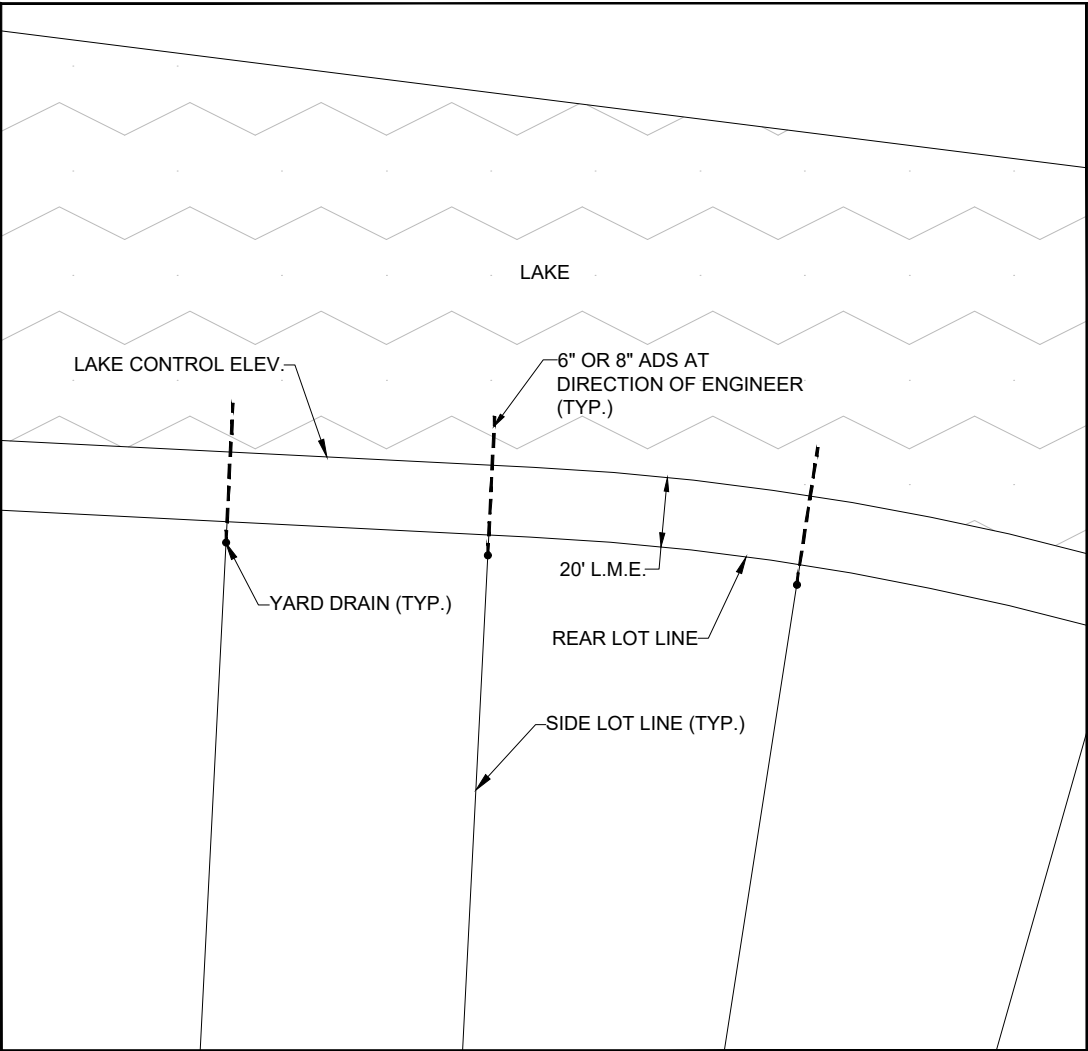

LAKE BANK WITH SECONDARY DRAINAGE

N.T.S.

NOTE: THIS SECTION IS OPTIONAL AND MAY BE IMPLEMENTED AT COMMON LOT LINES BY THE OWNER(S).

PREPARED FOR

WILDBLUE
COMMUNITY
DEVELOPMENT
DISTRICT

PROJECT DESCRIPTION

WILDBLUE
CDD

LEE COUNTY, FLORIDA

THIS PLAN IS PRELIMINARY AND
INTENDED FOR CONCEPTUAL
PLANNING PURPOSES ONLY.

SITE LAYOUT AND LAND USE
INTENSITIES OR DENSITIES MAY
CHANGE SIGNIFICANTLY BASED
UPON SURVEY, ENGINEERING,
ENVIRONMENTAL AND / OR
REGULATORY CONSTRAINTS
AND / OR OPPORTUNITIES.

DRAWING NOT VALID WITHOUT SEAL, SIGNATURE AND DATE
© COPYRIGHT 2023, BARRACO AND ASSOCIATES, INC.
REPRODUCTION, CHANGES OR ASSIGNMENTS ARE PROHIBITED

FILE NAME	J:\23620\DWG\LBR LAKE DETAILS.DWG
LOCATION	J:\23620\DWG\LBR\EXH1
PLOT DATE	THU, 6-29-2023 - 2:34 PM
PLOT BY	CHRIS PAULY

CROSS REFERENCED DRAWINGS

PLAN REVISIONS

PLAN STATUS

EXHIBIT

REAR LOT TO LAKE
DRAINAGE
EXHIBIT

PROJECT / FILE NO.	SHEET NUMBER
23620	EXH